

CM-V2W

Two-Valve Countertop or Wall-Mount Tower



Two-valve countertop or wall-mount tower designed for dispensing sparkling water and chilled still water in commercial beverage applications. Features 304 brushed stainless steel finish with two pull-handle, self-closing SSX faucets and lift-off drip pan. Designed to pair with all Crysalli remote chillers.

Features

- 304 Stainless steel, pull-handle SSX faucets
- Adjustable flow up to 2 oz/sec and lockable
- Self-closing when handle is released
- Faucets convertible to manual open-close function
- Downward-pointing nozzles
- Bottle filling clearance: 12"
- Tower height: 20.75"
- Ergonomic grip handles
- For use with all Crysalli remote chillers

Accessories

- Dispense levers:
 - CR-SDL-1: Single sanitary dispense lever that attaches to a self-closing faucet on unit. 1 per faucet. Great for self-service hands-free dispensing applications



CM-V2W

Two-Valve Countertop or Wall-Mount Tower



Scan for more resources!

Line Drawings

Front View

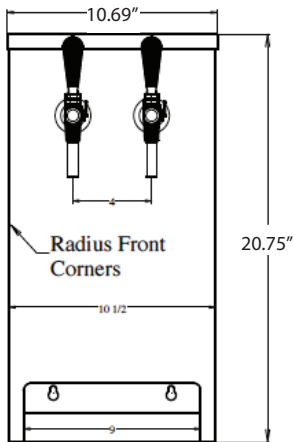

Side View

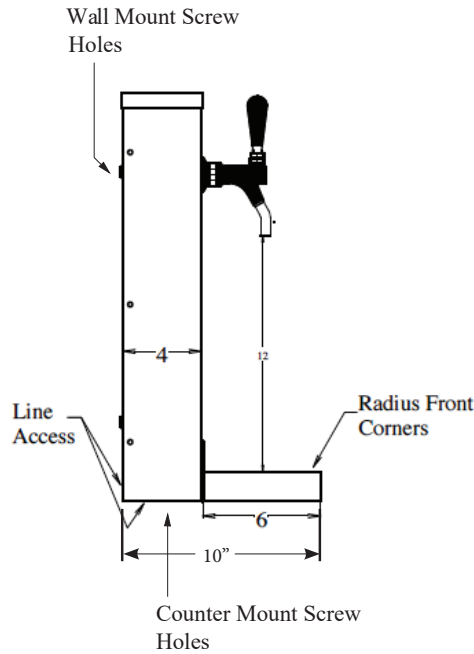

Mount Guides

Wall Mount

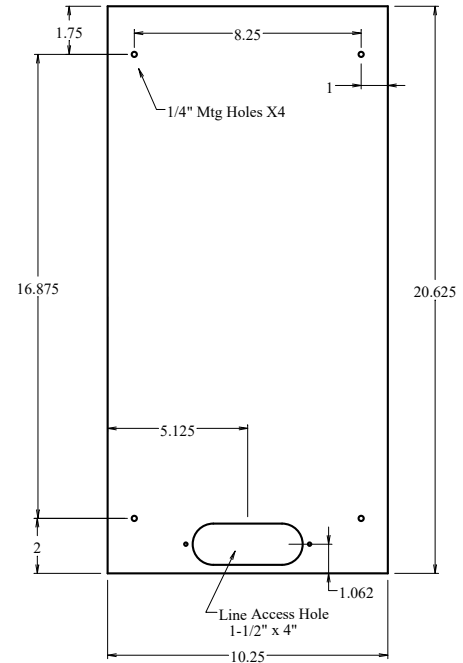

Top View

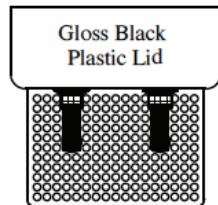

Counter Mount

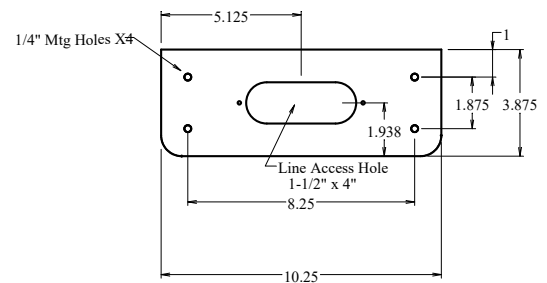

Rear line access panel

Wall mount screw holes

Mounting Hardware Not Supplied

| | |
|----------------------------------|--------|
| Width | 10.69" |
| Depth | 10" |
| Height (including 4" tap handle) | 20.75" |
| Bottle fill clearance | 12" |
| Weight | 10 lbs |

Issued 5/19/2026