

Project:



**Scan for more info!**

Owners manual  
Quick install  
Quick sizing  
Install layout  
Parts list

### CR-CWB1

## Single Cylinder Safety Restraint Wall Bracket



### CR-CWB2

## Dual Cylinder Safety Restraint Wall Bracket



### Specifications

- Powder coated steel bumper brackets
- Rubber edge trim
- Heavy duty nylon strap with quick release buckle
- Pre-drilled chain holes (chain not included)
- Pre-drilled anchor holes
- Mounting hardware not included. Mounting surface will determine hardware required for install
- Bracket should be mounted 2/3rds the height of the cylinder up from the floor



### CR-CWB1: Cylinder Safety Restraint Wall Bracket

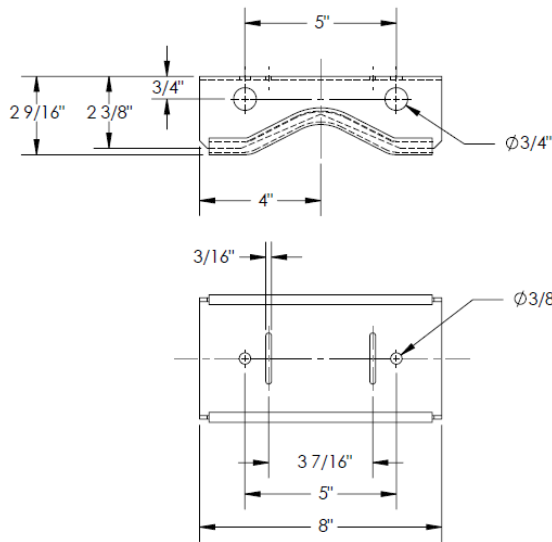

NOTE: CYLINDER SECURING STRAPS WITH TENSION LOCKS NOT SHOWN.

APPROX WEIGHT: 2.05 lbs.

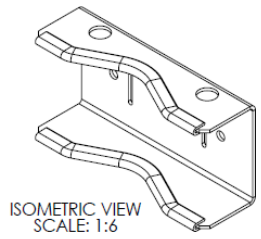

ISOMETRIC VIEW  
SCALE: 1:6

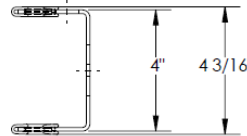

OVERALL WIDTH: 8"  
OVERALL DEPTH: 2 9/16"  
OVERALL HEIGHT: 4 3/16"  
MAX CAPACITY: ONE CYLINDER

### CR-CWB2: Dual Cylinder Safety Restraint Wall Bracket

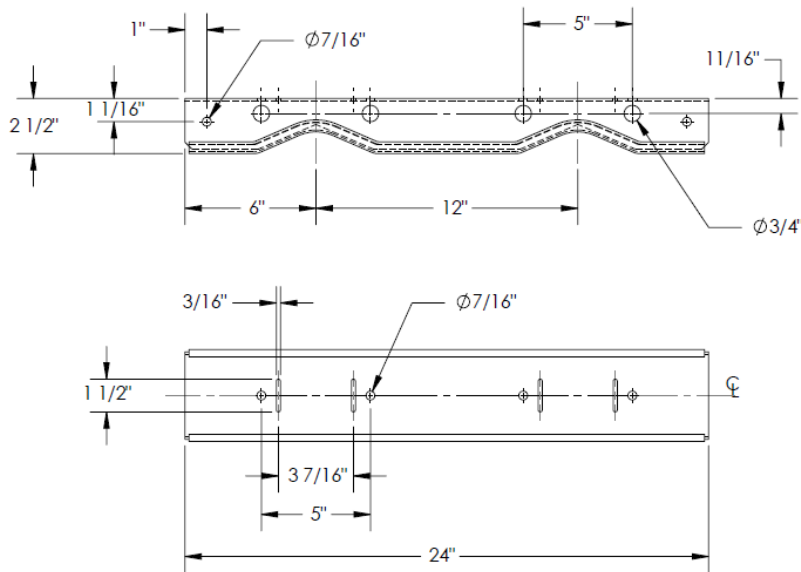

APPROX WEIGHT: 6.30 lbs.

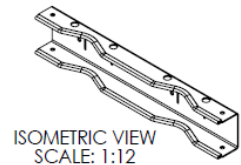

ISOMETRIC VIEW  
SCALE: 1:12

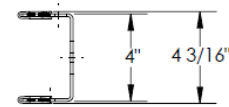

OVERALL WIDTH: 24"  
OVERALL DEPTH: 2 1/2"  
OVERALL HEIGHT: 4 3/16"  
MAX CAPACITY: TWO CYLINDERS



#### Accessories:

##### Gas Cylinder Auto Changeover Device

- CR-CTAC-2CK: CO2 Kit with hoses and primary reg
- CR-NTAC-2CK: N2 Kit with hoses and primary reg.

Automatically switches over empty gas cylinder to new full one.

No Electrical, works off pressures.

Can be used with 5 lbs through 50 lbs cylinders  
Great to double the capacity of small cylinders in cabinets.

